

**PARTS BREAKDOWN**

Call 1.800.221.9705 for questions concerning performance of the product or other inquiries.

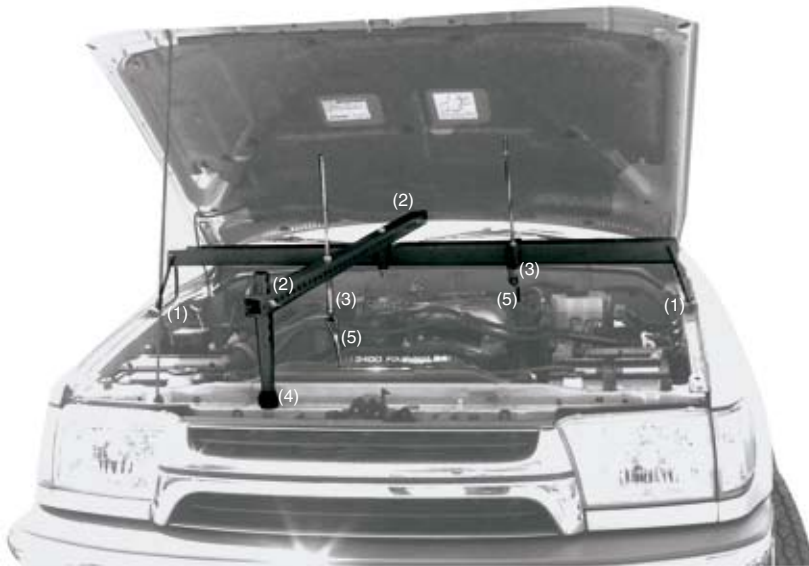

**OPERATING INSTRUCTIONS**

1. Test lip structure (Fig. 1) strength to assure adequate support prior to using this unit. The lip structure surface must be flat in order to prevent slippage of this unit. Mount the Transverse Support Bar with Support Arm on the area of the lip structure that is strongest.
2. Loosen the cap screw (Fig. 2) on the slide for adjustment.
3. To line up "J" hook (Fig. 3) with the engine bracket slide and/or pivot the arm into position.
4. The leg (Fig. 4) of the Third Arm Support must be on a solid surface at the front of the vehicle. Wing nut and cap screw can be removed to adjust the height of the leg into a leveled position.
5. Attach the engine to the Engine Transverse Bar. Hook the "J" hooks through the engine bracket. When no lifting eye is available, place the 1/8" braided steel cable (Fig. 5) around the engine and attach to the "J" hook. If the engine sags once attached to the Engine Transverse Bar, adjust the "J" hooks.

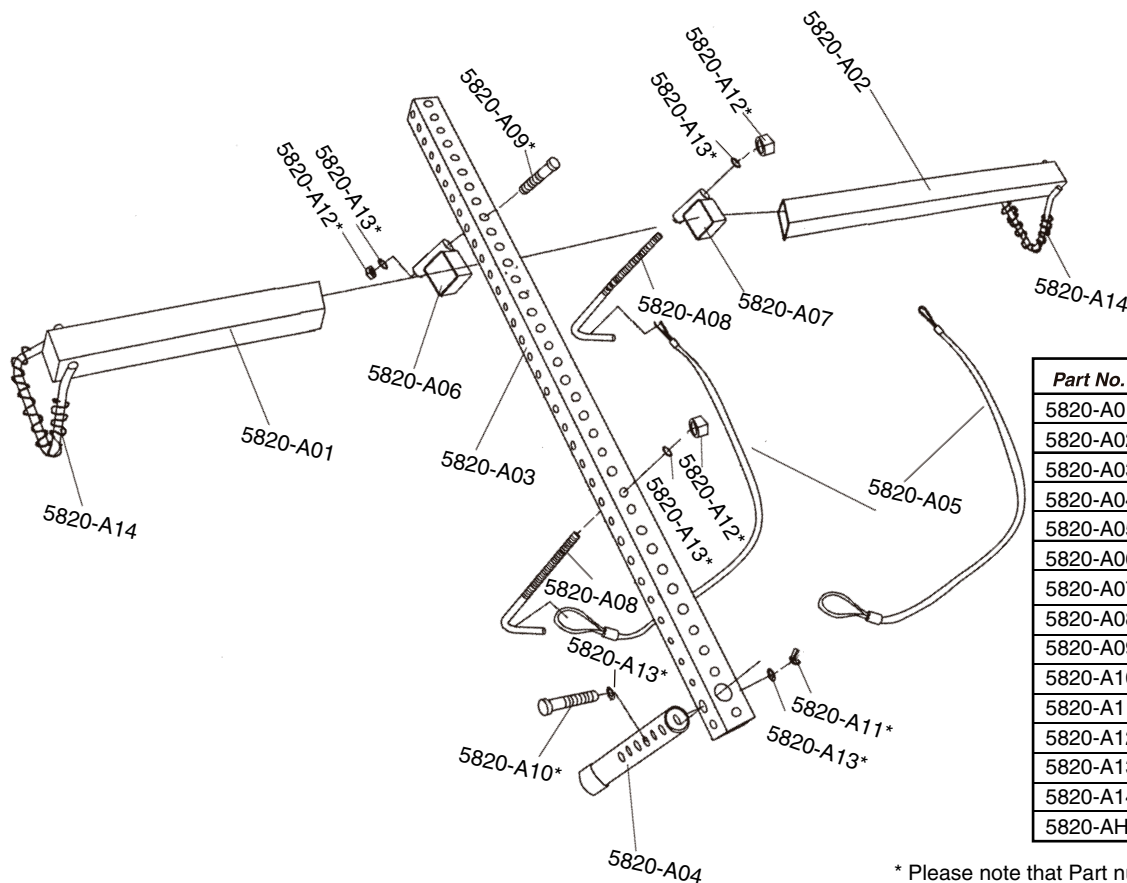

**Parts List**

Part No.	Description	Qty
5820-A01	Support Arm (Left)	1
5820-A02	Support Arm (Right)	1
5820-A03	Support Arm (Middle)	1
5820-A04	Leg	1
5820-A05	Sling	2
5820-A06	Big Slider	1
5820-A07	Small Slider	1
5820-A08	"J" Hook	2
5820-A09*	Cap Screw(M10x110mm)	1
5820-A10*	Cap Screw(M10x50mm)	1
5820-A11*	Wing Nut(M10)	1
5820-A12*	Hex Nut(M10)	3
5820-A13*	Washer(For M10 Bolt)	5
5820-A14	Protection Plastic Bar	2
5820-AHK	Hardware Kit (A09-A13)	1

\* Please note that Part numbers with an asterisk 5820-A09\*, 5820-A10\*, 5820-A11\*, 5820-A12\*, 5820-A13\* are only available in the Hardware Kit 5820-AHK and Not sold separately.