

Call 1.800.221.9705 for questions concerning performance of the product, local distributors or other inquiries.

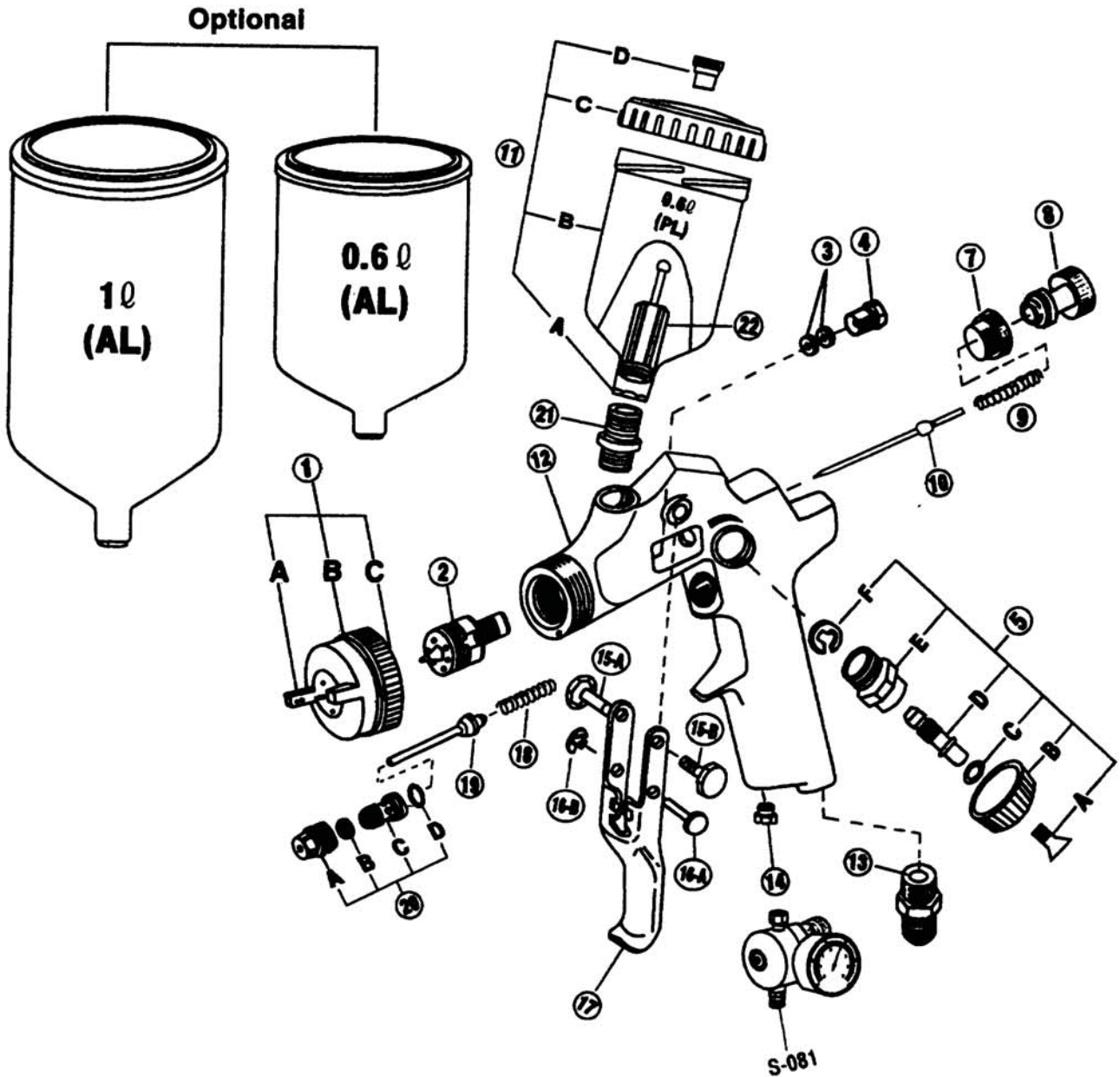

**For best performance and increased efficiency:
Use Regulator Part No. S-081 (Not included).**

NO.	DESCRIPTION	QTY	NO.	DESCRIPTION	QTY	NO.	DESCRIPTION	QTY
1	Air Cap Set G13/15 /17 /19	1	11	Cup— 0.6 l (PL)	1	17	Trigger	1
2	Fluid Nozzle G13/15 /17 /19	1		0.6 l (AL)/1 l (AL)		18	Air Valve Spring	1
3	Needle Valve Packing	2	12	Gun Body	1	19	Air Valve	1
4	Needle Valve Packing Seat	1	13	Air Hose Joint	1	20	Air Valve Seat Set	1
5	Spreader Adjusting Valve Set	1	14	Nut	1	20A	Air Valve Packing Seat	1
7	Lock Nut	1	15A	Trigger Screw	1	20B	Air Valve Packing	1
8	Fluid Adjusting Screw	1	15B	Trigger Stud	1	20C	Valve Body	1
9	Needle Valve Spring	1	16A	Trigger Pin	1	20D	O-Ring	1
10	Fluid Needle Set G13/15 /17 /19	1	16B	Trigger Stopper	1	21	Fluid Joint	1
						22	Filter	1